

SMCN-TYPE

※ Carbide, Nut Type

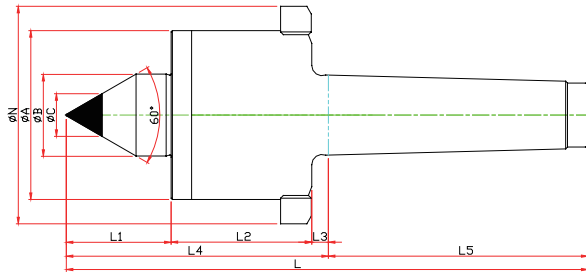

unit:mm/kg

Model	Morse Taper	Dimension											Weight Max. (lbs)	R.P.M Max.	Run out (inch)
		GL	A	B	C	D	E	F	G	N	T	L			
LC-3SMCN	NO.3	23,825	52	22	30	51	5	86	81	70	10	167	661.39	12000	0,00011811
LC-4SMCN	NO.4	31,267	66	32	41	55	6.5	102.5	101.5	85	14	204	2425.09	10000	0,00011811
LC-5SMCN	NO.5	44,399	82	40	51	75	6.5	132.5	129.5	105	16	262	4850.17	8000	0,00019685

※SPECIAL sizes or dimensions are available with quick turnaround

SMBCN-TYPE

※ SHAFT EXTENTION(Minimize the bite-interference)
 ※ Carbide, Nut Type

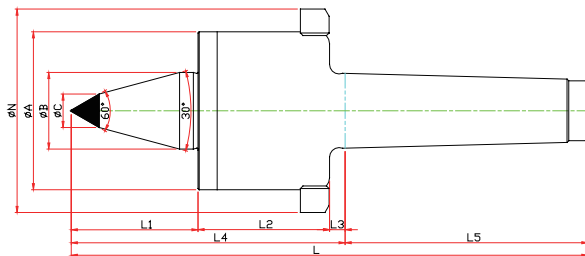

unit:mm/kg

Model	Morse Taper	Dimension											Weight Max. (lbs)	R.P.M Max.	Run out (inch)	
		GL	A	B	b	L1	L2	L3	L4	L5	C	N				L
LC-3SMBCN	NO.3	23,825	52	22	10	40	51	5	96	81	10	70	177	727.53	12000	0,00011811
LC-4SMBCN	NO.4	31,267	66	32	14	50	55	6.5	111.5	101.5	14	85	213	2425.09	10000	0,00011811
LC-5SMBCN	NO.5	44,399	82	40	16	65	75	6.5	146.5	129.5	16	105	276	4850.17	8000	0,00019685

※SPECIAL sizes or dimensions are available with quick turnaround